

- EN** Tighten hardware until it is secure.
⚠ **DO NOT OVERTIGHTEN HARDWARE.**
- DE** Befestigungsteile sicher festziehen.
⚠ **BEFESTIGUNGSTEILE NICHT ZU FEST ANZIEHEN.**
- FR** Serrer fermement les vis.
⚠ **NE PAS TROP SERRER LES VIS.**



WEBER-STEPHEN PRODUCTS LLC
www.weber.com

© 2023 Designed and engineered by Weber-Stephen Products LLC,
1415 S. Roselle Road, Palatine, Illinois 60067 USA.

9500113_011923

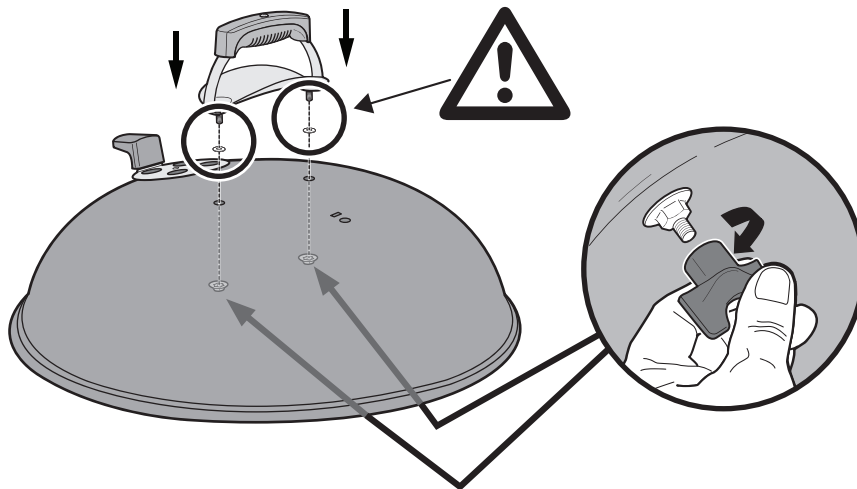
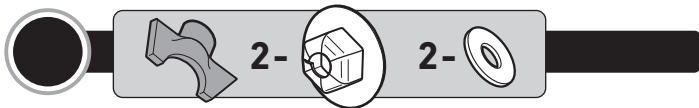

- EN** Tighten hardware until it is secure.
⚠ **DO NOT OVERTIGHTEN HARDWARE.**
- DE** Befestigungsteile sicher festziehen.
⚠ **BEFESTIGUNGSTEILE NICHT ZU FEST ANZIEHEN.**
- FR** Serrer fermement les vis.
⚠ **NE PAS TROP SERRER LES VIS.**



WEBER-STEPHEN PRODUCTS LLC
www.weber.com

© 2023 Designed and engineered by Weber-Stephen Products LLC,
1415 S. Roselle Road, Palatine, Illinois 60067 USA.

9500113_011923